

Mira Logic Shower Fittings

Adjustable Range

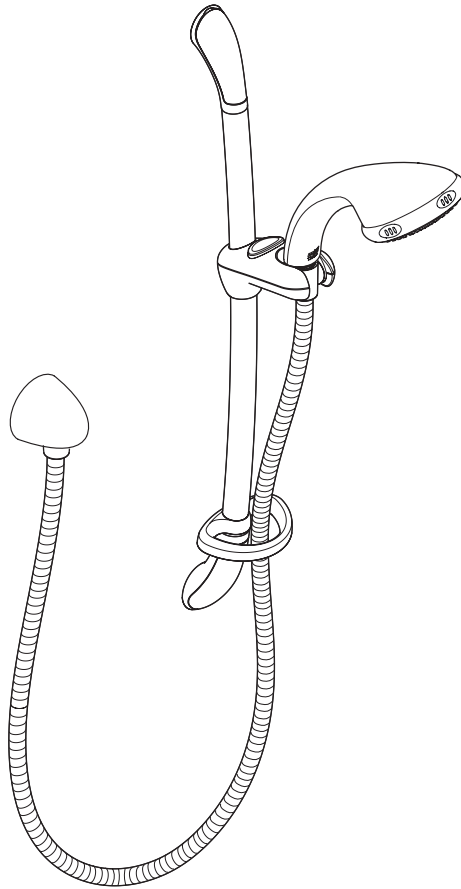

These instructions must be left with the user

If you experience any difficulty with the installation or operation of your new shower fittings, then please refer to **"Fault Diagnosis"**, before contacting Kohler Mira Limited.

Installation & User Guide

Showering perfection

mira
SHOWERS

Important Safety Information

Warning!

- 1. Products manufactured by us are safe and without risk provided they are installed, used and maintained in good working order in accordance with our instructions and recommendations.
- 2. Only suitable for Mixer and Digital showers.

Caution!

- 1. Read all of these instructions and retain this guide for later use.
- 2. Pass on this guide in the event of change of ownership of the installation site.
- 3. Follow all warnings, cautions and instructions contained in this guide.
- 4. Anyone who may have difficulty understanding or operating the controls of any shower should be attended whilst showering. Particular consideration should be given to the young, the elderly, the infirm, or anyone inexperienced in the correct operation of the controls.
- 5. When this product has reached the end of its serviceable life, it should be disposed of in a safe manner, in accordance with current local authority recycling, or waste disposal policy.

Introduction

This Installation and User Guide covers the following products:

Mira Logic Exposed Variable Shower Fittings (ev)

An adjustable spray handset with four different spray actions, supplied complete with flexible hose, clamp bracket assembly, slide bar, supports and hose retaining ring/gel holder. Available in chrome finish.

Mira Logic Built-in Variable Shower Fittings (biv)

Offering the same features as the Logic ev but also includes a right angle connector (RAC). Suitable for connection to concealed pipework supplies. Available in chrome finish.

Guarantee

This product has been designed for **domestic** use only, Mira Showers guarantee this product against any defect in materials or workmanship for a period of two years from the date of purchase (shower fittings for one year). For terms and conditions, refer to the back cover of this guide.

Recommended Usage

| Recommended Usage | |
|-------------------|---|
| Domestic | ✓ |
| Light Commercial | ✗ |
| Heavy Commercial | ✗ |
| Healthcare | ✗ |

Pack Contents

Tick the appropriate boxes to familiarize yourself with the part names and to confirm that the parts are included.

Mira Logic ev and biv Shower Fittings

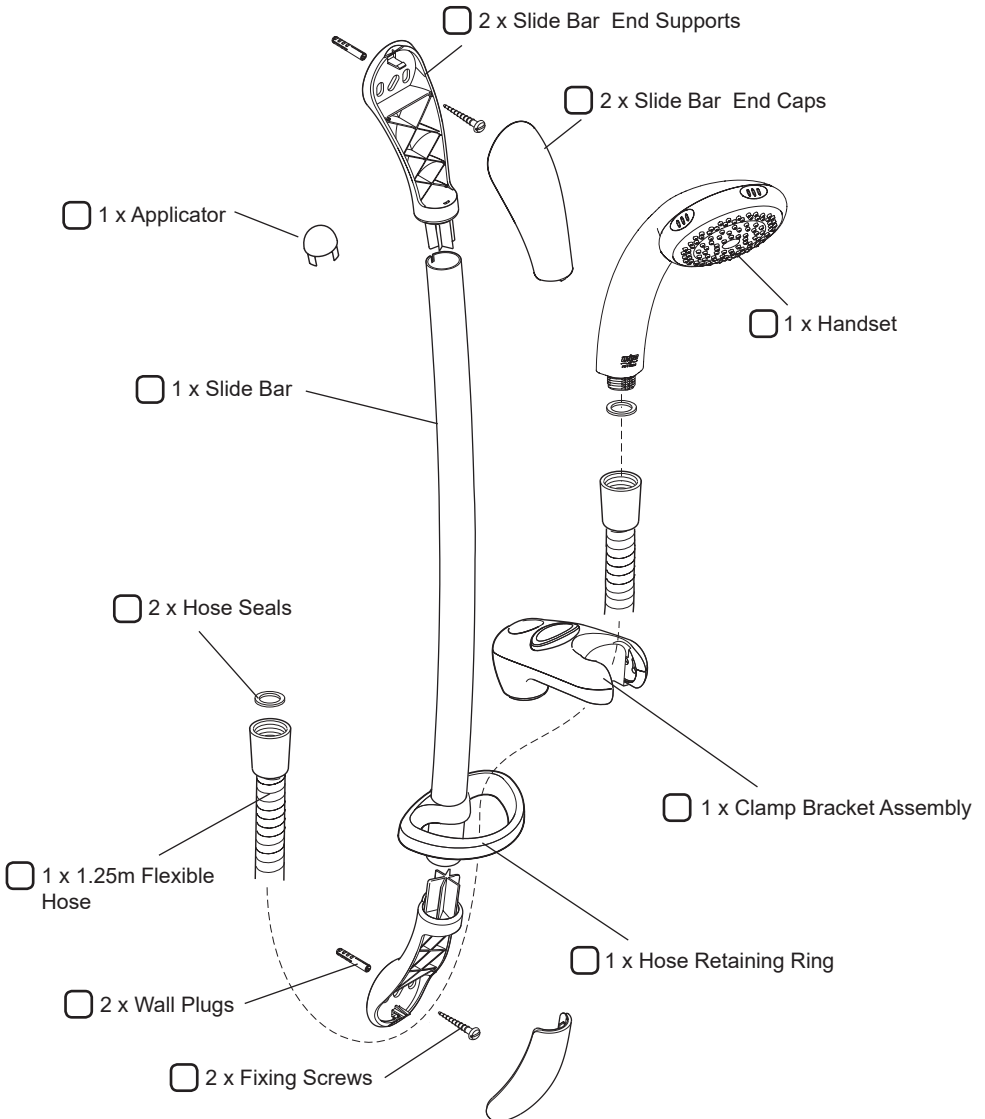

Mira Logic biv Shower Right Angle Connector Fittings Pack

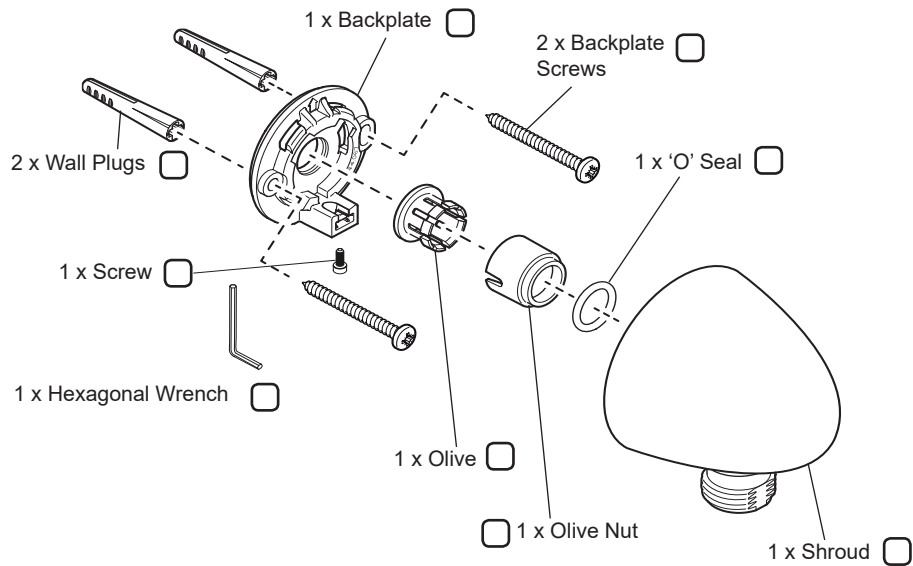

Dimensions

Mira Logic ev and biv Shower Fittings

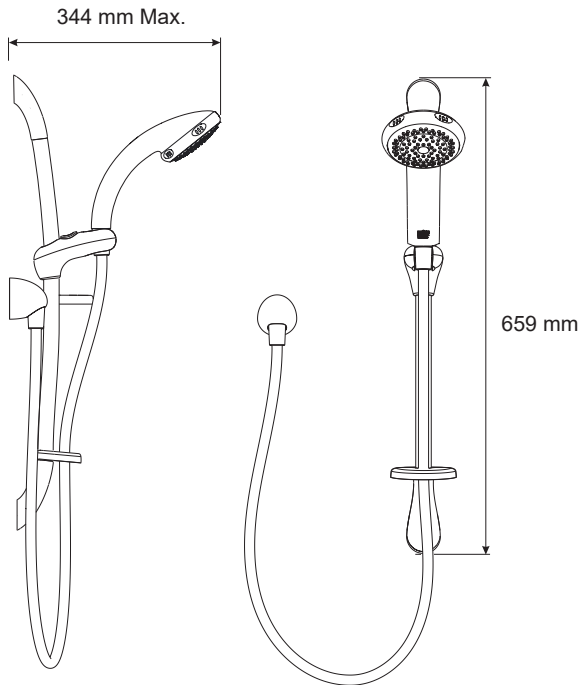

Specifications

Minimum maintained pressure: **0.1 bar**

Maximum maintained pressure: **5.0 bar**

Warning! Exceeding the stated maximum maintained pressure could result in excessive spray forces and possible damage to the product.

These are the typical flow performance graphs for the Mira Logic adjustable shower fittings only. There will be an additional pressure loss through the shower control.

Pressure loss = Pressure difference between the inlet and outlet of the fitting.

Flow Rates

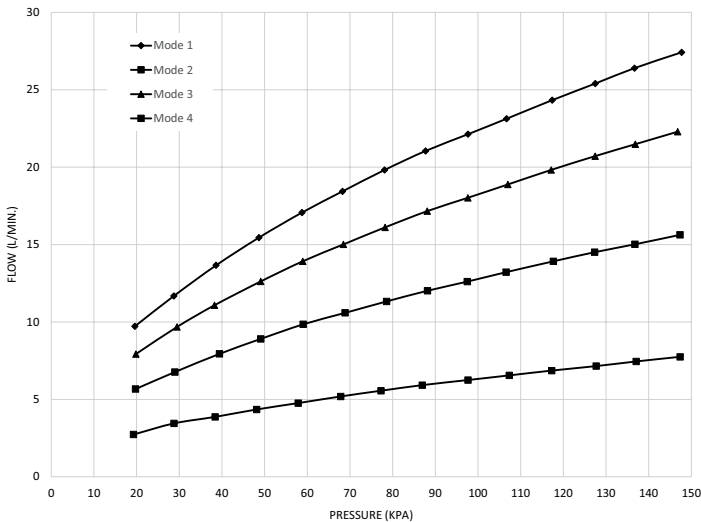

Installation Requirements

Installation must be carried out in accordance with these instructions, and must be conducted by designated, qualified and competent personnel.

1. The hose retaining ring supplied **must** be used to stop the handset from dropping below the spill-over level of the bath or shower tray. This will prevent water supply contamination due to backsiphonage.
2. Installations **must** comply with UK Water Regulations/ Bye-laws (Scotland), and Building and Plumbing Regulations in force at the time of installation.
3. When installing the shower fittings in a cubicle, position with the spray pointing across rather than toward the opening of the cubicle.
4. When installing the shower fittings over a bath, position with the spray pointing down the centre line of the bath.
5. Avoid layouts where the shower hose will be sharply kinked. This may reduce the life of the hose.
6. **Do not** fit any form of flow control in the shower outlet.
7. **Do not** use excessive force when making connections.

8. The minimum pressure required for a satisfactory spray pattern to form, at the handset or spray head, is 0.1 bar. For a gravity fed shower installation the minimum head of water required, to accommodate the pressure loss in the pipes and shower control of a typical installation, is 1.0 metre.

For a pump installation the minimum acceptable vertical distance between the base of the cold water storage cistern and the shower head to operate the pump's flow switches, is typically 0.6 m (600 mm).

Installation

Note! For dry lined, stud partition, shower cubicle or laminated panel walls the installer may wish to obtain alternative proprietary cavity fixings. Use of these alternative fixings is beyond the scope of this guide.

Important! If the Logic slide bar replaces an existing Mira slide bar make sure that the position of the shower control and the shower fittings provide a minimum of 25 mm between the handset and bath/tray spill-over level. This is necessary to prevent back-siphonage. If this is not possible then the new slide bar will have to be repositioned.

Mira Logic Exposed Variable Shower Fittings (ev)

Read the section: **Installation Requirements** before proceeding with the installation.

The slide bar should be positioned to one side of the shower control at a convenient height for all the family. It should be positioned so that the handset discharges down the centre line of the bath, or across the opening of the shower cubicle. The handset should be directed away from the shower control.

1. Decide on a suitable position for the slide bar avoiding buried cables and pipes. Make sure that when the hose retaining ring is placed on the lowest position on the slide bar there is a minimum of 25 mm between the handset and bath/tray spill-over level. This is necessary to prevent back-siphonage.
2. **Important!** The slide bar has been supplied with an applicator fitted to one end (refer to illustration) to assist the assembly of the slide bar through the hole in the clamp bracket. Take care not to dislodge the constant friction mechanism or the friction pad.

With the clamp bracket button **FULLY** depressed carefully ease the slide bar through the hole in the clamp bracket. Take care not to dislodge the constant friction mechanism or the friction pad.

3. Release the clamp bracket button. Remove the applicator from the slide bar and store in a safe place for future use.
4. Slide the hose retaining ring onto the slide bar below the clamp bracket.

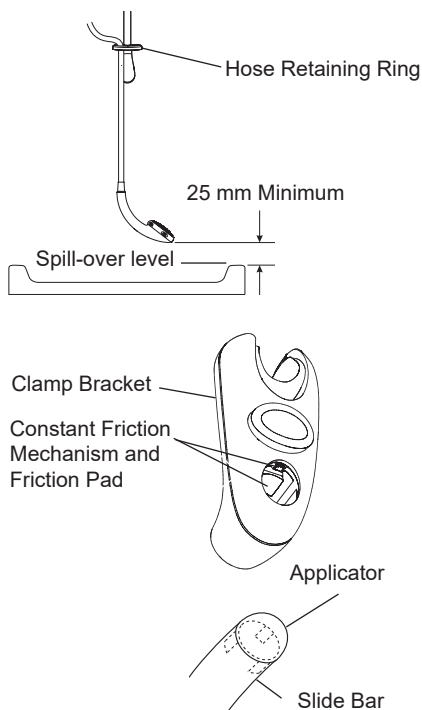

5. Make sure that the slots in the slide bar are aligned with the lugs in the support and fit the two slide bar supports to the ends of the slide bar. Make sure that each support is pushed firmly home.

Note! If replacing an existing Mira Slide Bar proceed to instruction 8.

6. Using the assembled slide bar and supports as a template, mark the position of the two fixing holes using the centre slot.

Warning! Make sure that there are no buried cables or pipes in the wall before drilling.

7. Drill the two 7 mm holes for the fixing screws and insert the wall plugs supplied. (Alternatively use proprietary cavity fixings for dry lined, stud partition, shower cubicle or laminated panel walls).
8. Fix the bottom slide bar support to the wall using the screw provided. Make sure that the screw is fully tightened.
9. Loosely screw the top slide bar support to the wall. Press firmly down on the top slide bar support and, while continuing to apply force, fully tighten the screw.
10. Fit the end caps to the slide bar supports.
11. Check the slide bar cannot be rotated or vertically moved. If there is movement remove the slide bar assembly from the wall. Check the slide bar support lugs are properly engaged with the slots in the slide bar and the supports are pushed fully onto the slide bar ends. Refit the slide bar assembly.
12. Refer to sections: **Handset Installation** to complete the fittings installation.

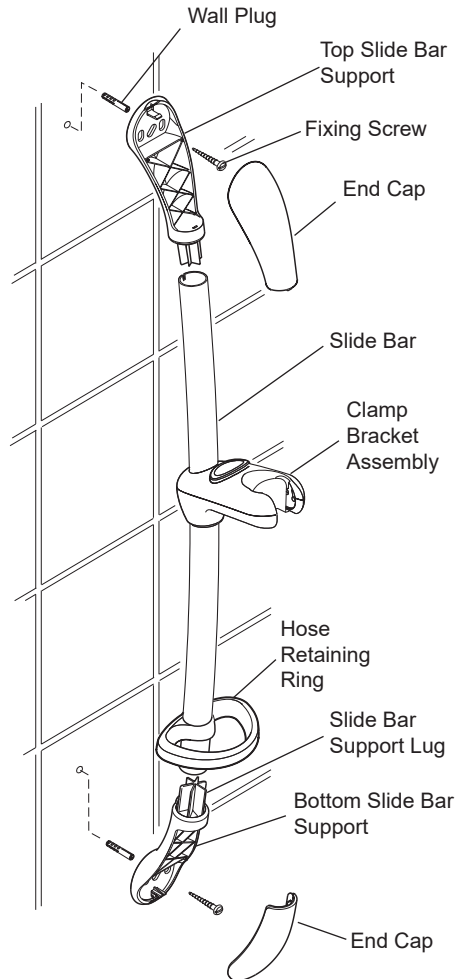

Handset Installation

Caution! Do not overtighten the hose.

1. Screw the hose onto the outlet of the shower control (Make sure that the hose washer is fitted).
2. Pass the flexible hose through the hose retaining ring and screw the remaining end of the hose onto the handset (Make sure that the hose washer is fitted).
3. Place the handset in the clamp bracket assembly.

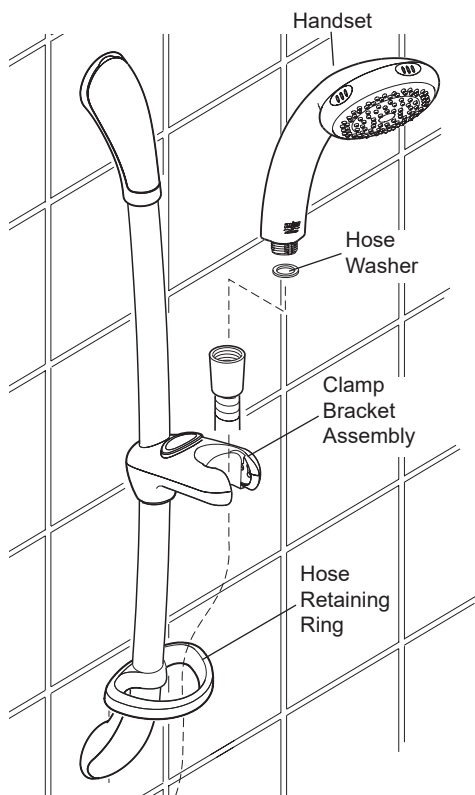

Installation of the Right Angle Connector

1

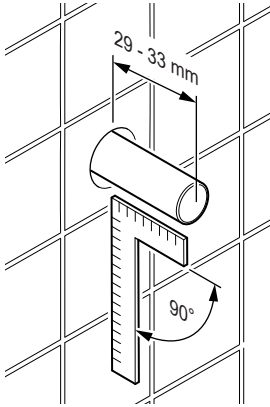

Trim the pipework back to the required depth from the finished wall surface. Remove all burrs and sharp edges.

2

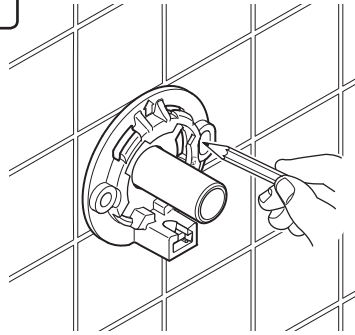

Disassemble the right angle connector assembly and mark the locations of the screw fixings.

3

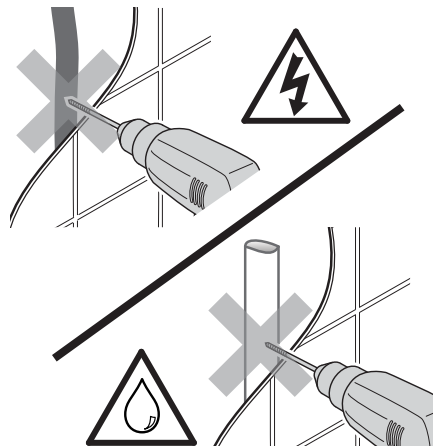
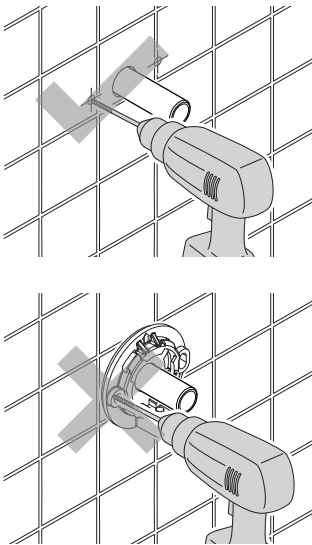

Drill the fixing holes. (7 mm diameter for screws supplied.)

DO NOT drill through the backplate into the wall.

DO NOT drill into buried cables or pipes.

4

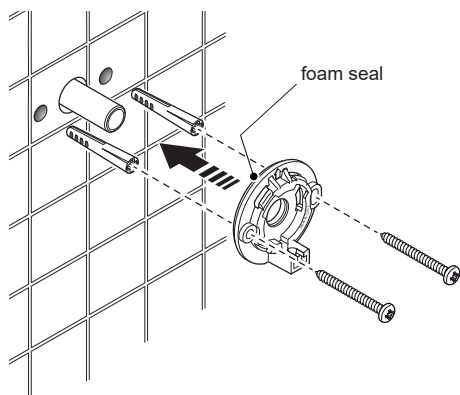

Secure the backplate to the wall so the foam seal is fully compressed.

5

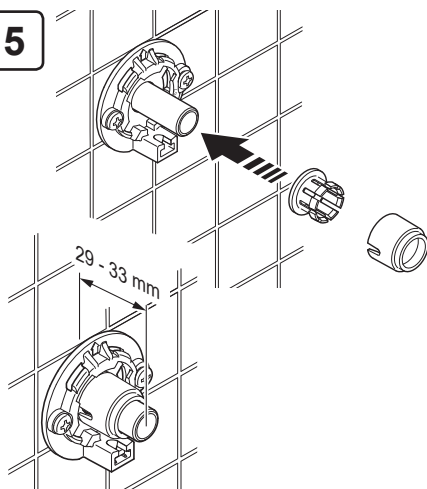

Fit the pipe collar and lock. Re-check the pipe length.

6

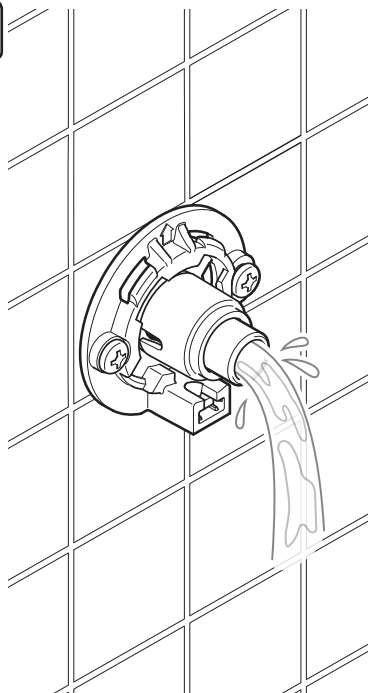

Flush pipework to clear all debris.

7

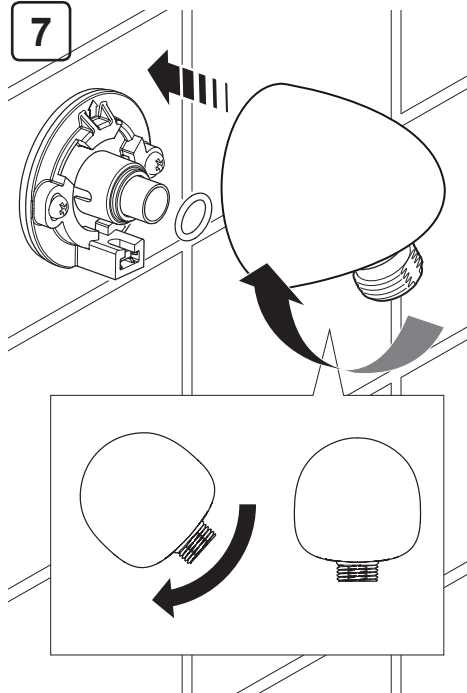

Install the O ring over the pipe. Fit the cover and twist to lock.

8

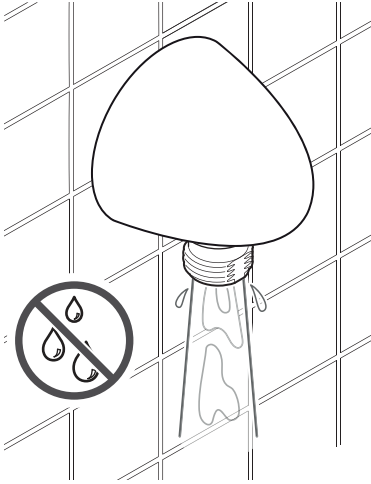

Check for leaks.

9

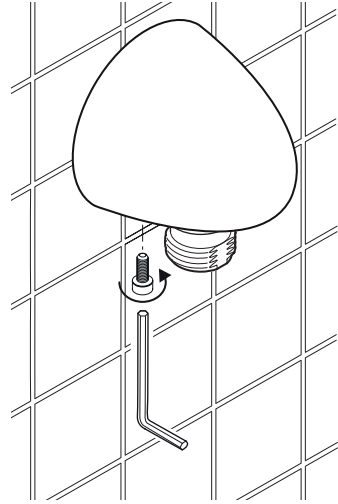

Tighten the screw using the 3 mm hex key supplied to lock the assembly.

10

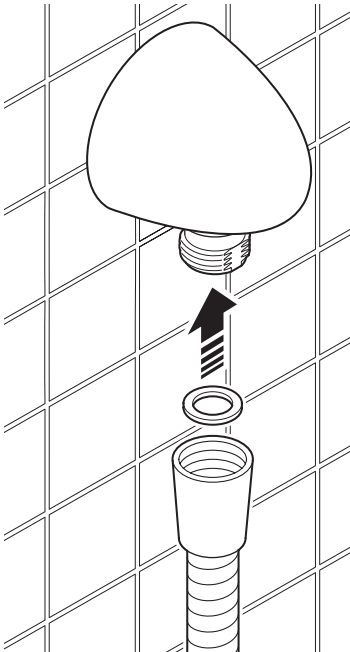

Fit a shower hose with a 15 mm rubber washer.

Operation

Changing Spray Settings

The handset has four different spray Modes.

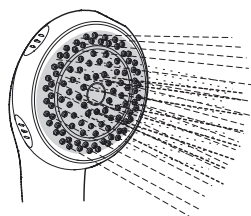

Mode 1
Full ON

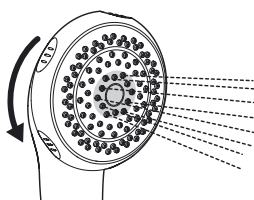

Mode 2
First Row ON

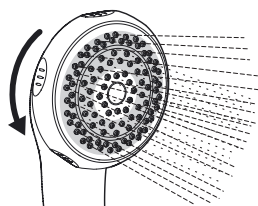

Mode 3
Second to fifth
row ON.

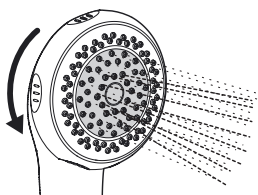

Mode 4
First, second
and third row
ON.

Clamp Bracket Adjustment (ev and biv shower fittings only)

1. Depress the release button and slide the clamp bracket assembly to the required position.

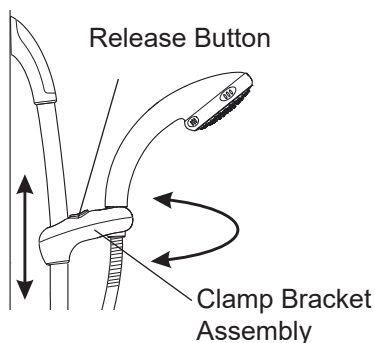

2. Move the handset to the required angle. A friction mechanism within the clamp bracket assembly will hold the handset at the desired angle.

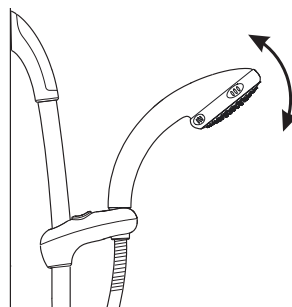

Fault Diagnosis

The trouble shooting information tabled below gives details on what you can do as a user, should you encounter difficulties with the shower fittings whilst operating the shower. Before replacing any parts make sure that the underlying cause of the malfunction has been resolved.

| Malfunction | Cause | Remedy |
|---|--|---|
| No flow or low flow rate from the Showerhead. | Spray plate blocked. Hose blocked or twisted. Partially closed stop or servicing valve in supply pipe work to the shower control. Head of water below minimum required. Problem with shower control. | Refer to section: Maintenance, Cleaning. Clear blockage or release twist in hose or renew hose. Open valve. Raise cistern or fit Mira pump. Refer to the shower control Installation and User Guide. |
| Drip from spray plate assembly in handset. | A small amount of water may be retained in the Showerhead after the shower control has been turned off. This may drain over a few minutes. Problem with shower control. | This is quite normal. Changing the angle of the shower fitting may vary the draining time. Refer to the shower control Installation and User Guide. |
| Shower temperature changes when spray action is adjusted. | Adjusting the spray action changes the flow of water. This may affect some shower controls and plumbing installations. | To minimise the effect make sure that the spray plate is clean. Refer to section: Maintenance, Cleaning. If the the malfunction persists refer to the shower control Installation and User Guide. |
| The spray force is uncomfortably strong. | High pressure shower installation. | Fit 9 L/min flow regulator. |

Maintenance

Cleaning

Many household cleaners contain abrasives and chemical substances, and should not be used for cleaning plated or plastic fittings. These finishes should be cleaned with a mild washing up detergent or soap solution, and then wiped dry using a soft cloth.

Spray Plate Assembly - External

1. Use your thumb or a soft cloth to wipe any limescale from the soft rubber nozzles and the front face of the spray plate assembly.

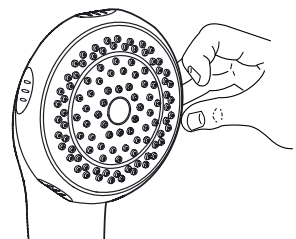

Spares

Mira Logic ev and biv Spares Diagram

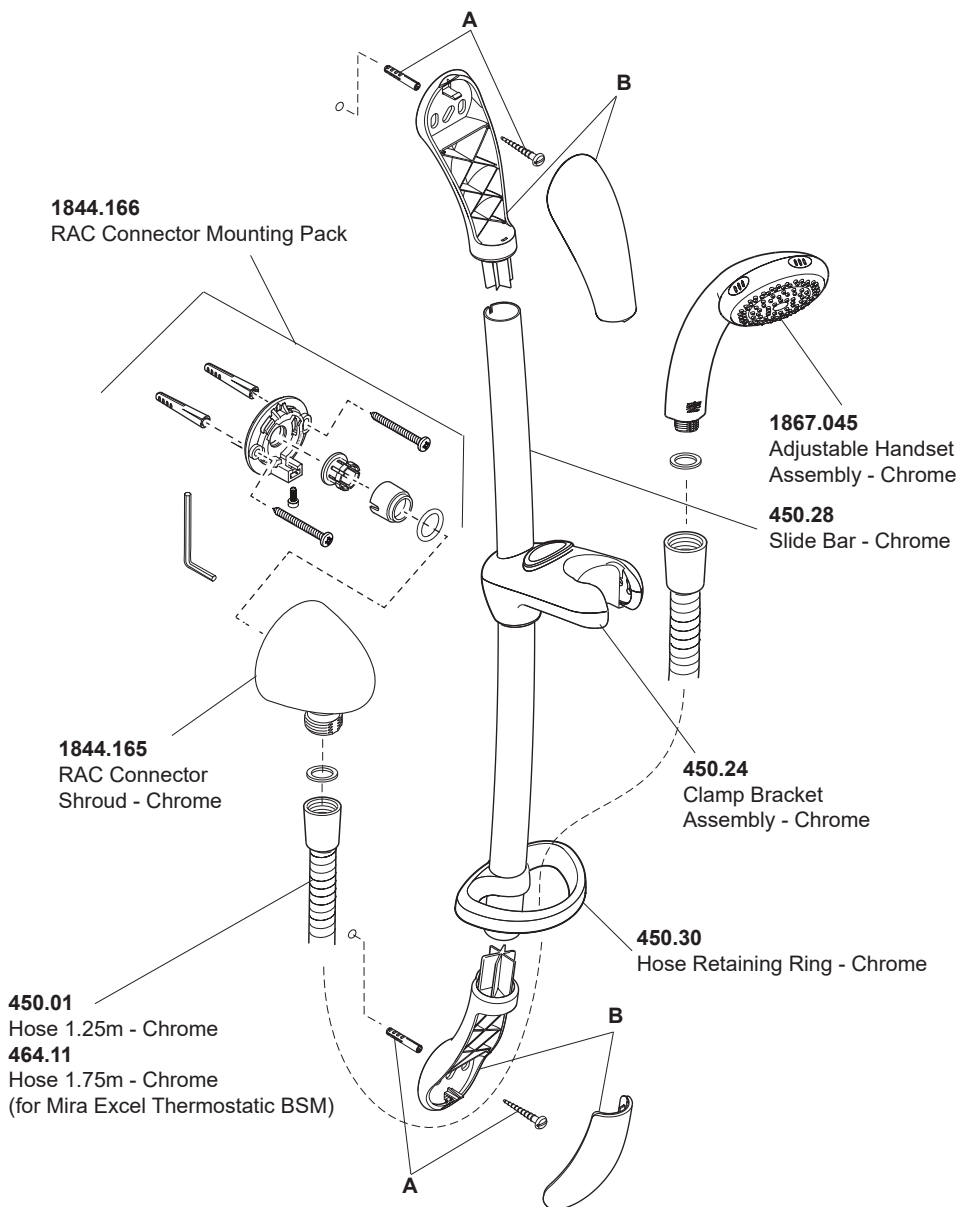

450.17 Slide Bar Wall Fixing Pack - Components Identified 'A'

450.27 Slide Bar Support Assembly - Components Identified 'B'

Notes

Customer Service

Guarantee

Your product has the benefit of our manufacture's guarantee which starts from date of purchase. This guarantee only applies in the United Kingdom and Republic of Ireland. To activate this guarantee, please return your completed registration card, visit our website or free phone 0800 5978551 within 30 days of purchase (UK only).

Within the guarantee period we will resolve defects in materials or workmanship, free of charge, by repairing or replacing parts or product as we may choose.

This guarantee is in addition to your statutory rights and is subject to the following conditions :

- The guarantee applies solely to the original installation under normal use and to the original purchaser only. The product must be installed and maintained in accordance with the instructions given in this guide.
- Servicing must only be undertaken by us or our appointed representative.
Note! If a service visit is required the product must be fully installed and connected to services.
- Repair under this guarantee does not extend the original expiry date. The guarantee on any replacement parts or product ends at the original expiry date.
- For shower fittings or consumable items we reserve the right to supply replacement parts only.

The guarantee does not cover:

- Call out charges for non product faults (such as damage or performance issues arising from incorrect installation, improper use, inappropriate cleaning, lack of maintenance, build up of limescale, frost damage, chemical attack, corrosion, system debris or blocked filters) or where no fault has been found with the product.
- Water or electrical supply, waste and isolation issues.
- Compensation for loss of use of the product or consequential or indirect loss of any kind.
- Damage or defects caused if the product is repaired or modified by persons not authorised by us or our appointed representative.
- Routine maintenance or replacement parts to repaired or modified by persons not authorised by comply with the requirements of the TMV2 or repaired or modified by persons not authorised by TMV3 healthcare schemes
- Accidental or wilful damage.
- Products purchased ex-showroom display.

What to do if something goes wrong

If your product does not work correctly refer to this manual for fault diagnosis and check that it is installed and commissioned in accordance with our instructions. If this does not resolve the issue, contact us for help and advice.



Helpdesk Service

Contact our Customer Services Team for product advice, to purchase spare parts or accessories or to set up service visit. You can contact us via phone or e-mail - contact details below.

Please provide your model name, power rating (if applicable) and date of purchase.



Mira Showers Website

(www.mirashowers.co.uk)

Visit our website to register your guarantee, download user guides, diagnose faults, purchase our full range of accessories and popular spares, or request a service visit.



Spares and Accessories

We hold the largest stocks of genuine Mira spares and accessories. Contact us for a price or visit our website to purchase items from our accessory range and popular spares. (Only available in the United Kingdom)



Service/Repairs

No one knows our products better than our nationwide team of Service Technicians. We can carry out service or repair work to your product both during and after the guarantee period. (Only available in the United Kingdom and Republic of Ireland) Ask about our fixed price service repairs.

To Contact Us: UK



0800 001 4040



Fax: 01242 282595



Email – Visit

www.mirashowers.co.uk/contactus



By Post: **Mira Customer Services Dept, Cromwell Road, Cheltenham, Gloucestershire GL52 5EP**

To Contact Us: Eire Only



01 531 9337



E-mail:

CustomerServiceEire@mirashowers.com

*Mira is a registered trade mark of
Kohler Mira Limited.*

*The company reserves the right to alter
product specifications without notice.*



mira
SHOWERS