

**A**

Maxi Grip Safe User Load : Maxi Grip Joiner 120kg

90°

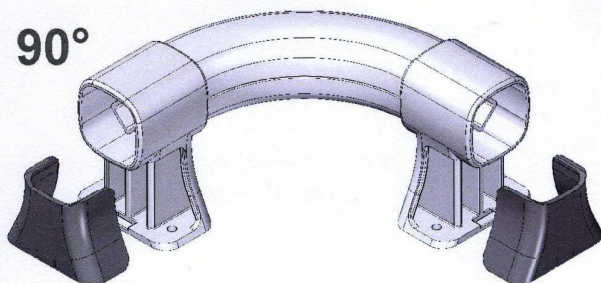

45°

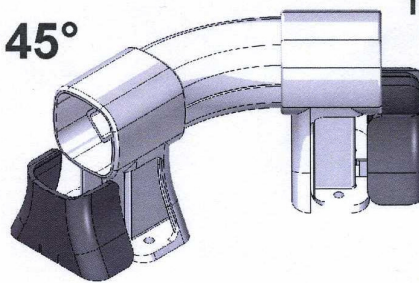
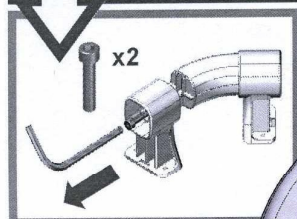
**B**

Option - Internal or External corner

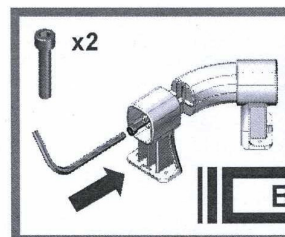
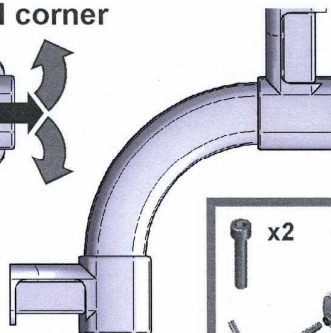
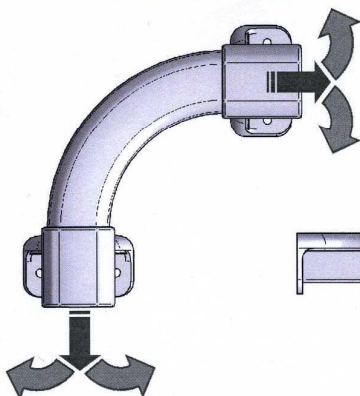
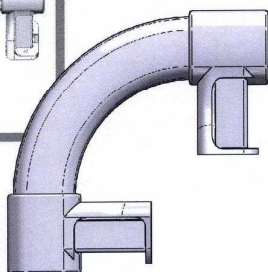
**B**

Option - 30° 45° 60°



Medium grit

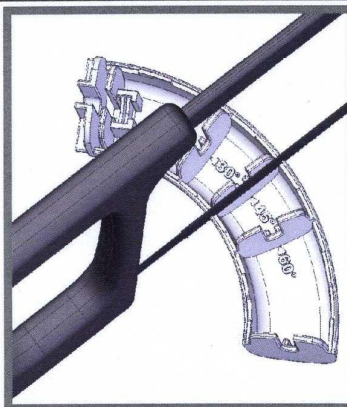
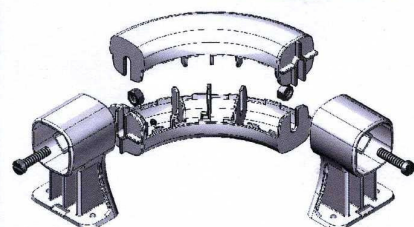

x2

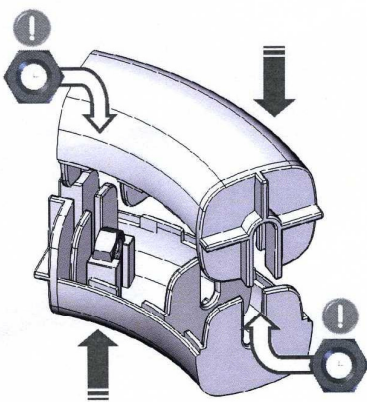
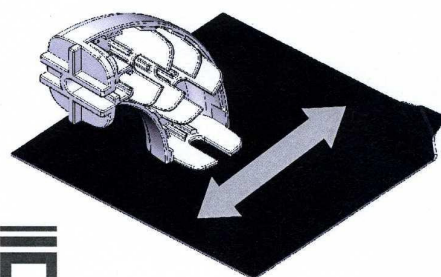

x2

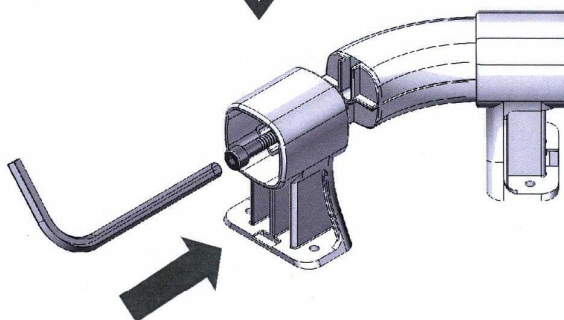

Ensure the 2 bolts are fully tightened

**B****impey**Conquest Business Park, Old Way, Ilton, Somerset, TA19 9EA  
Tel::01460256080 Fax: 01460 259800 [www.impey-uk.com](http://www.impey-uk.com)

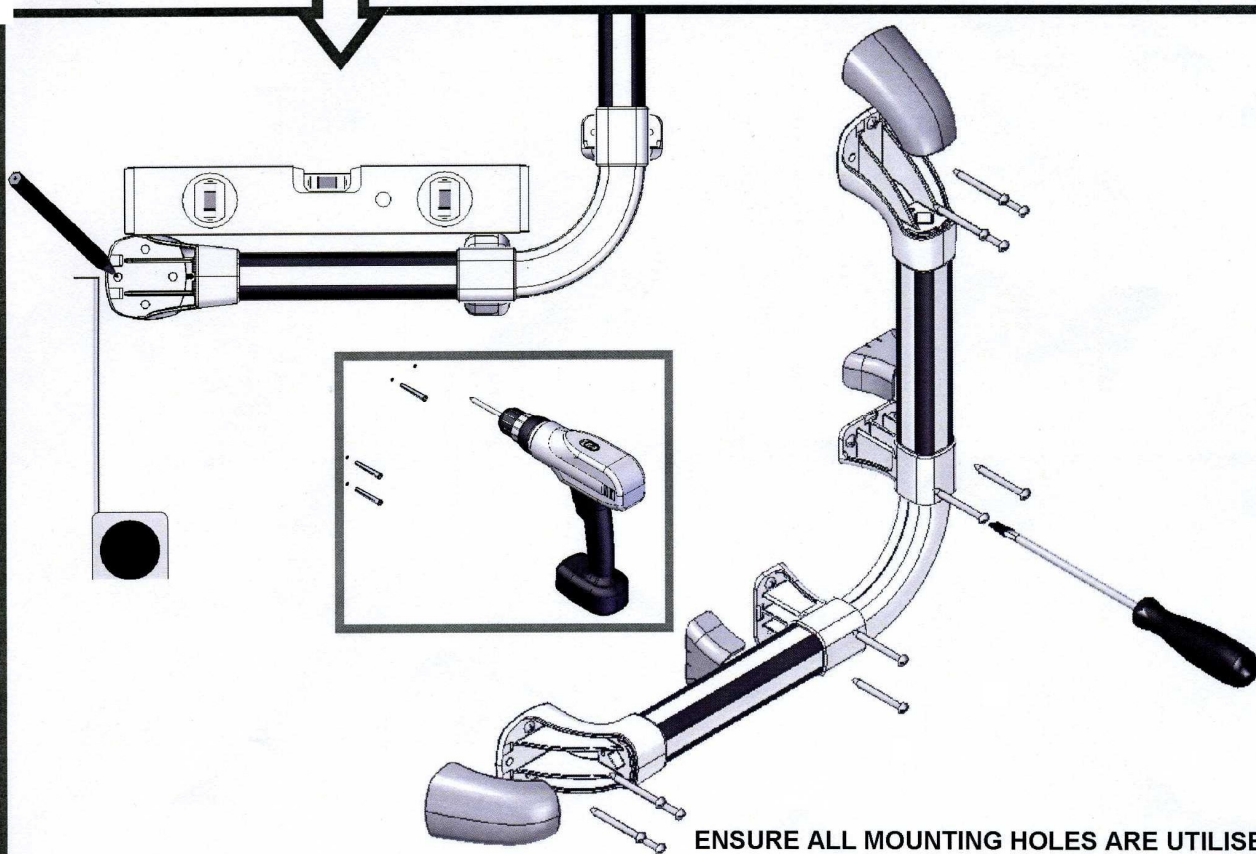
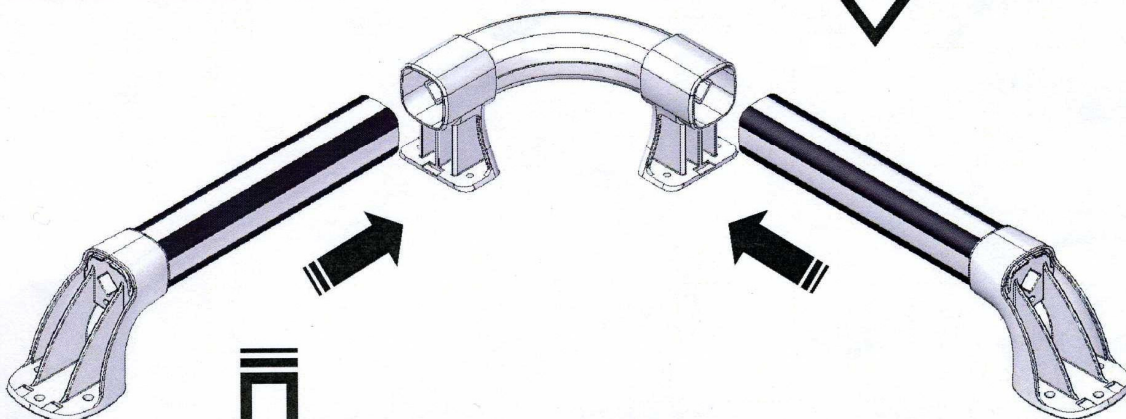
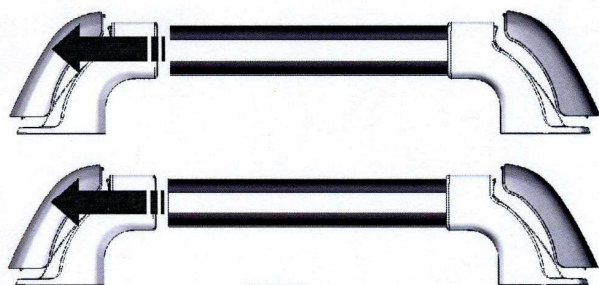
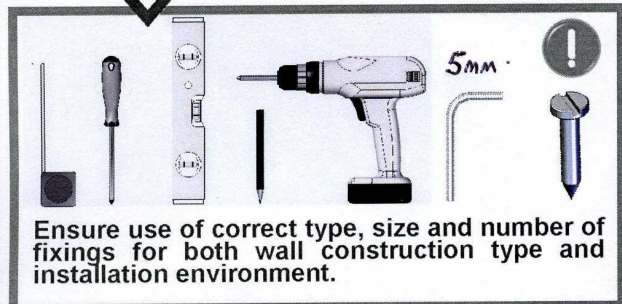

**B**

Maxi Grip joiner should be installed only in combination with Maxi Grip grab rails.

Part No:71419 00

**impey**

Designed and made in the U.K.

For maintenance and installation guide refer to Maxi Grip grab rail instruction sheet PART No: 71418 00